

Appendix 10: Ordnance Survey maps

10A: OS 'Old Series'

Sheet number: 18

Survey date: 1811

Scale: 1:63,360



10B: OS Old Series David & Charles reprint

Sheet number: Sherborne 84

Source: Extract supplied by Respondent 8

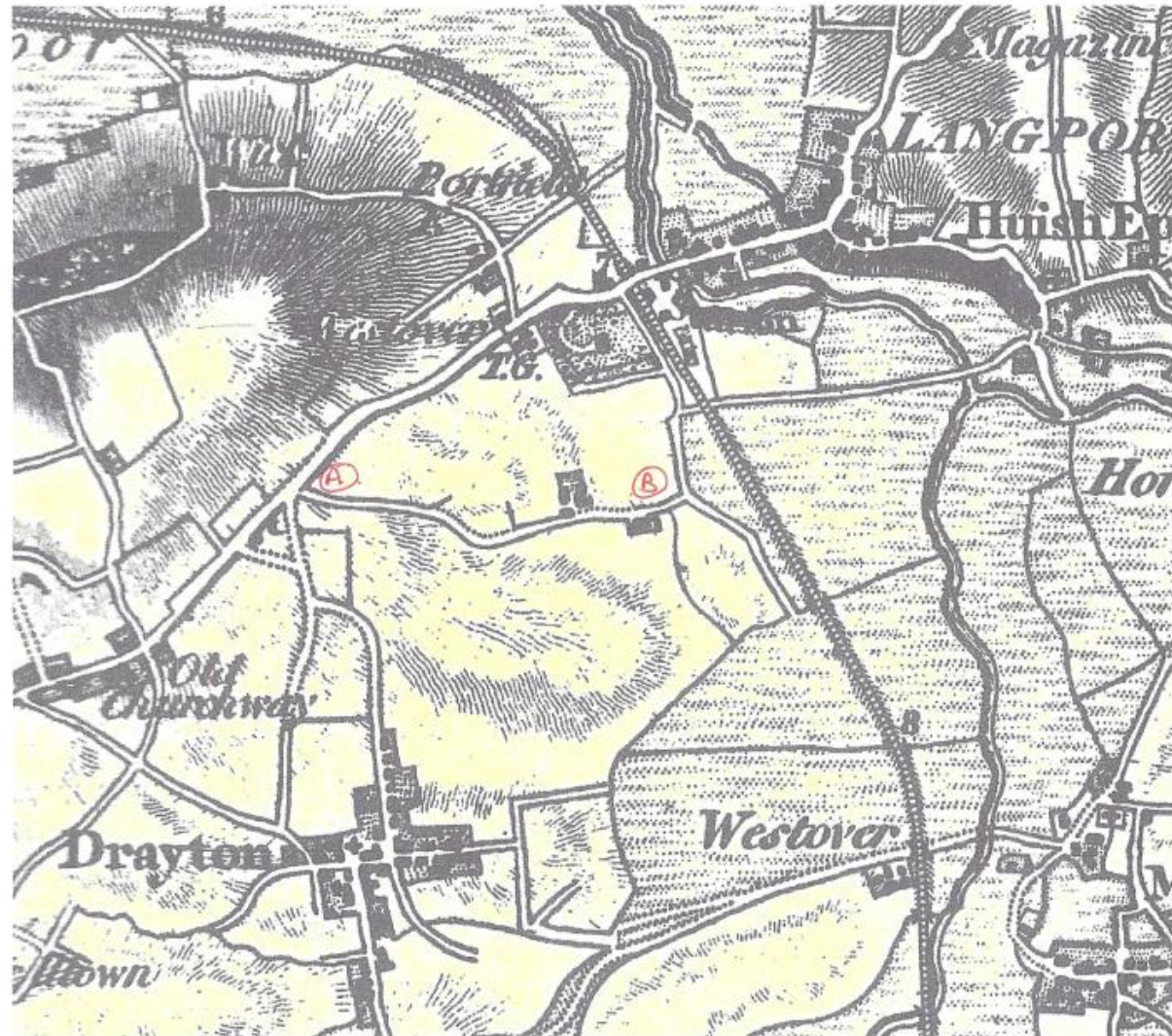

10C: OS Boundary Remark Book 1883

Source: The National Archive

Reference: OS 26/9279

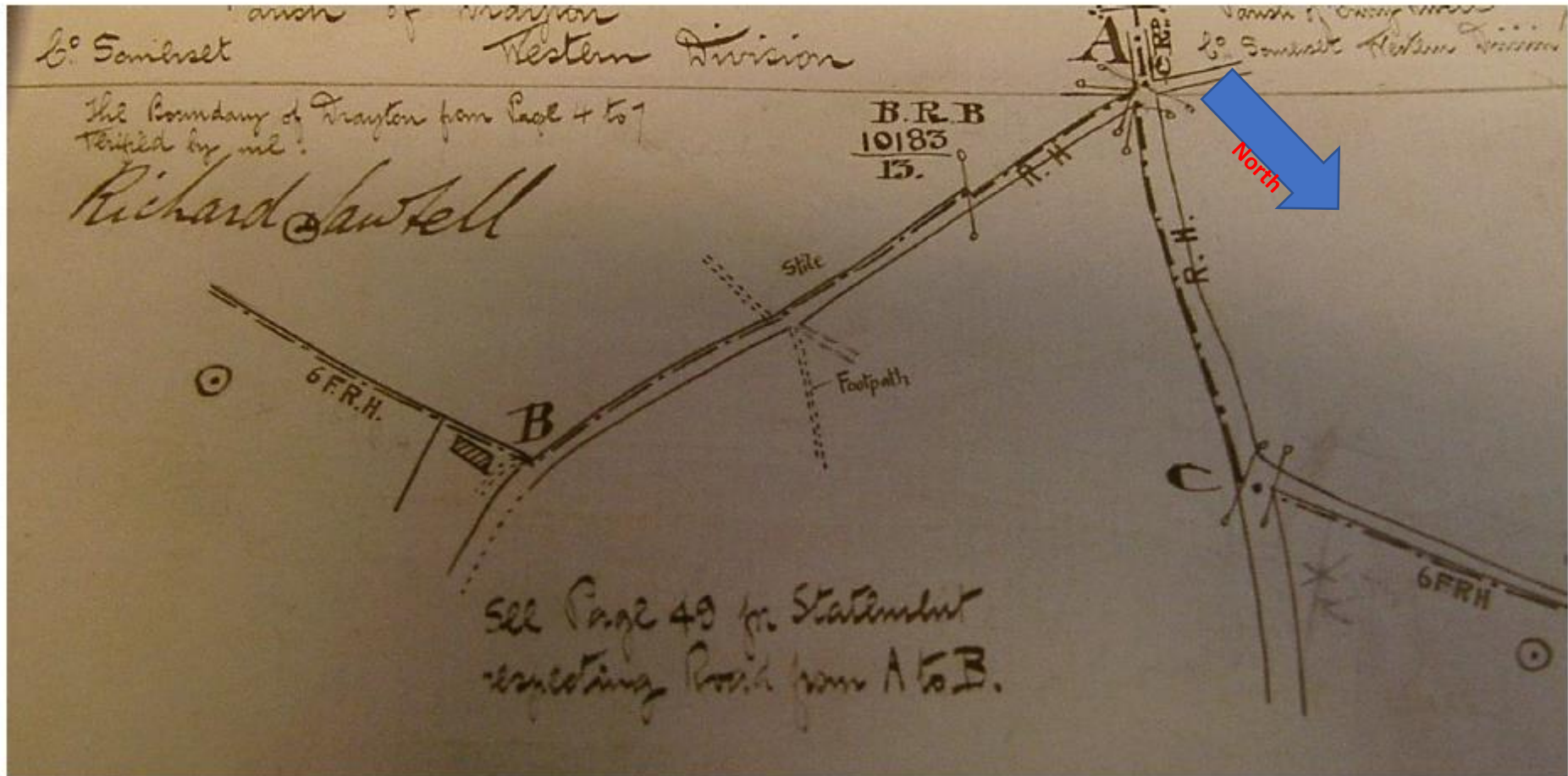

49
With reference to the Road shown on Page 7 I beg to
say this is a private road to my farm and that
I have paid for the repair of this Road for upwards
of 20 years and that I consider this Road to be
in Huish Episcopi Parish. Road from point marked
A to point marked B
Thomas Mead Drayton
Langport 22/5/83

With reference to the Road shown on Page 7 I beg to say this is a private road to my farm and that I have paid for the repair of this Road for upwards of 20 years and that I consider this Road to be in Huish Episcopi Parish. Road from point marked A to point marked B.

Thomas Mead Drayton Langport 22/5/83

10D: OS Boundary Sketch Map 1885

Source: The National Archive

Reference: OS 27/4600

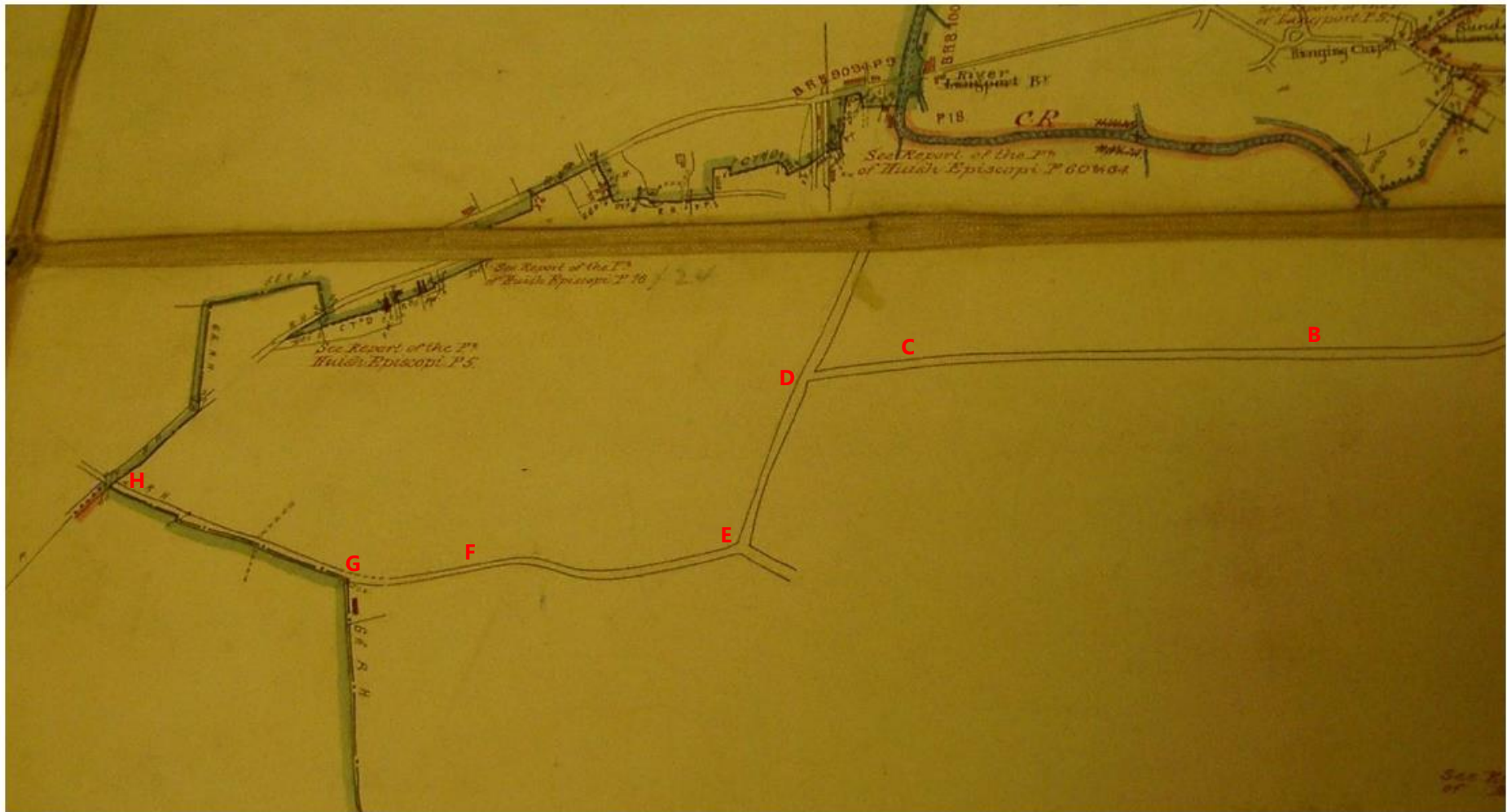

10E: OS County Series First Edition 25 Inch Map

Sheet numbers: Somerset LXXII.8 and LXXII.7

Survey Date: 1886

Scale: 1:2500





10F: OS Revised New Series Timeline Reprint

Source: supplied by applicant

Sheet: 193

Survey Date: 1898-1900

Scale: 1:63,360

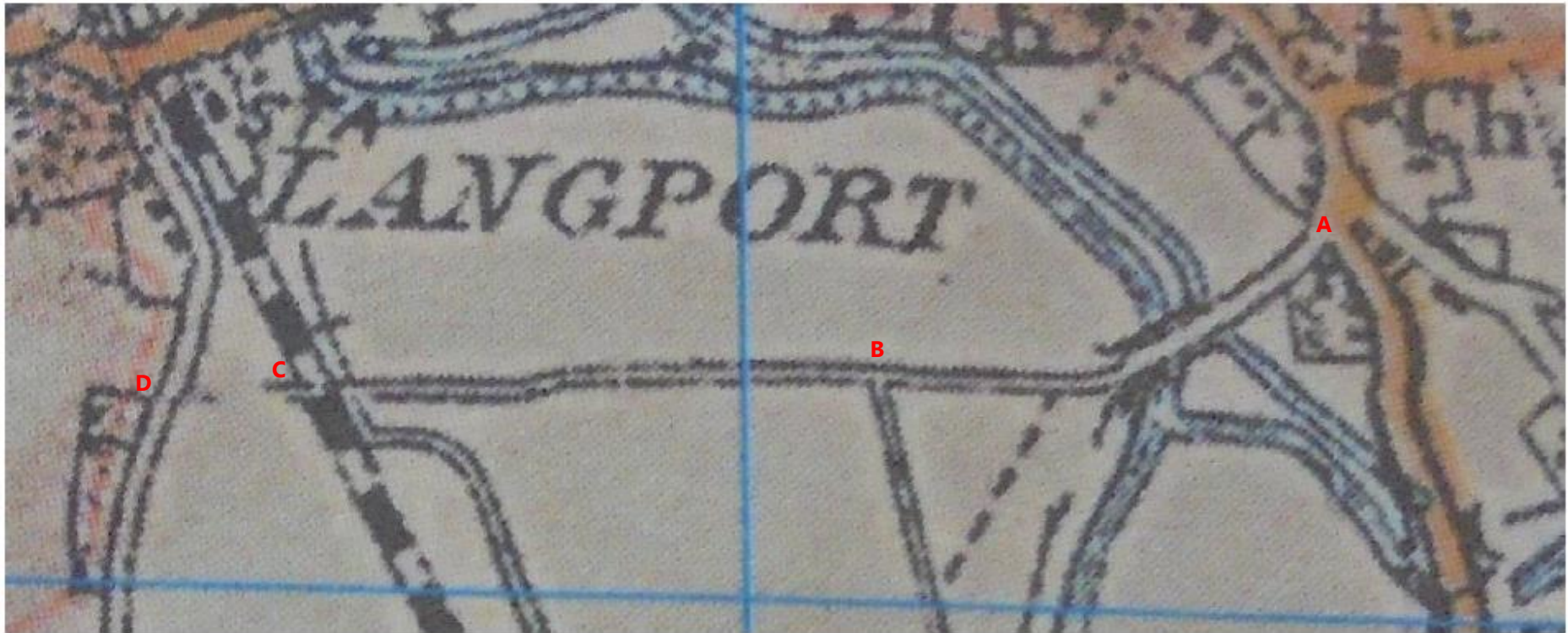

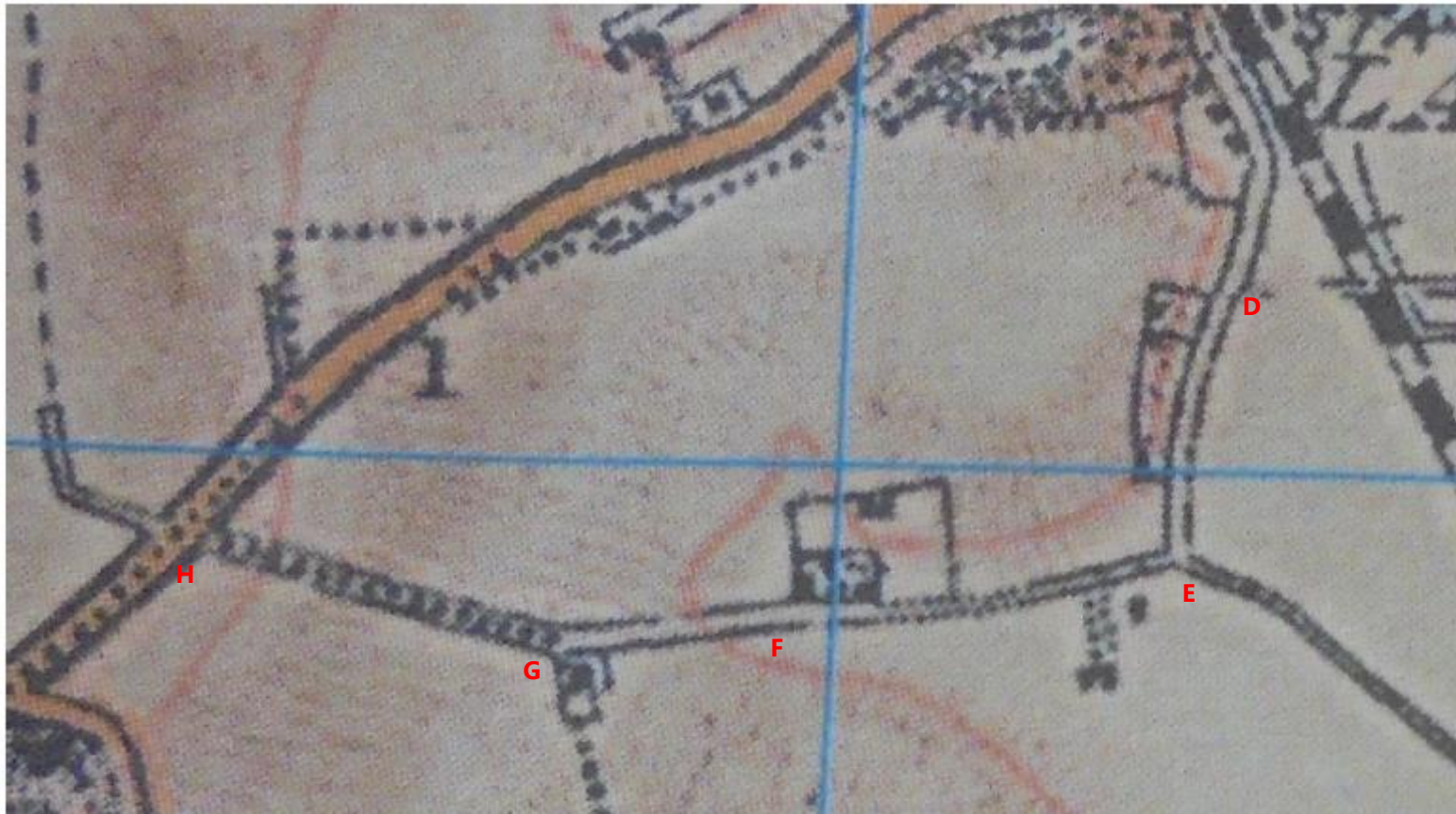

<i>Metalled Roads; First Class</i>	} <i>Fenced</i> {	5 (Mile distance)	} <i>Unfenced</i> {
" " <i>Second Class</i>		(Attitude) 211	
" " <i>Third Class</i>			
<i>Unmetalled Roads</i>			

10G: OS County Series Second Edition 25 Inch Map

Sheet numbers: Somerset LXXII.8 and LXXII.7

Survey date: 1886; Revised: 1901

Scale: 1:2500





10H: OS Popular Edition

Sheet number: 193

Survey date: 1919

Scale: 1:63,360





	Surface	Good & fit for fast traffic	Fit for ordinary traffic	Indifferent or winding road	Bad
Main Routes between Towns Other Roads	over 14' of Metalling				
Roads under 14' wide					
Minor Roads					
Bridle & Footpaths					
(Private Roads are uncoloured. Unfenced Roads are shown by dotted lines)					
		Slopes steeper than $\frac{1}{4}$			
		Toll Gates			

10I: OS County Series Third Edition 25 Inch Map

Sheet numbers: Somerset LXXII.8 and LXXII.7

Survey date: 1886; Revised: 1928

Scale: 1:2500



